







The contractor is responsible for the verification of dimensions on the site. All dimensions are in millimetres. © Copyright all rights reserved South Tyneside Council. Ordnance Survey data has been reproduced from Mastermap with the permission of The Controller of H.M. Stationery Office. Crown copyright reserved. Licence No. 100019570

- KEY:**
-  Full depth flexible footway construction
 -  Footway resurfacing / reconstruction (flags to flexible)
 -  Raised Table
 -  Tactile Paving - Red

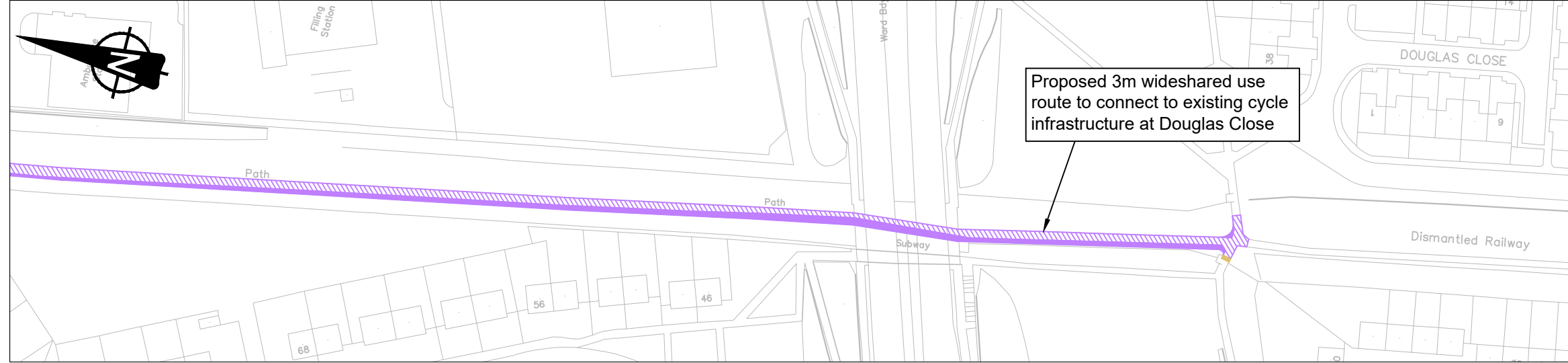
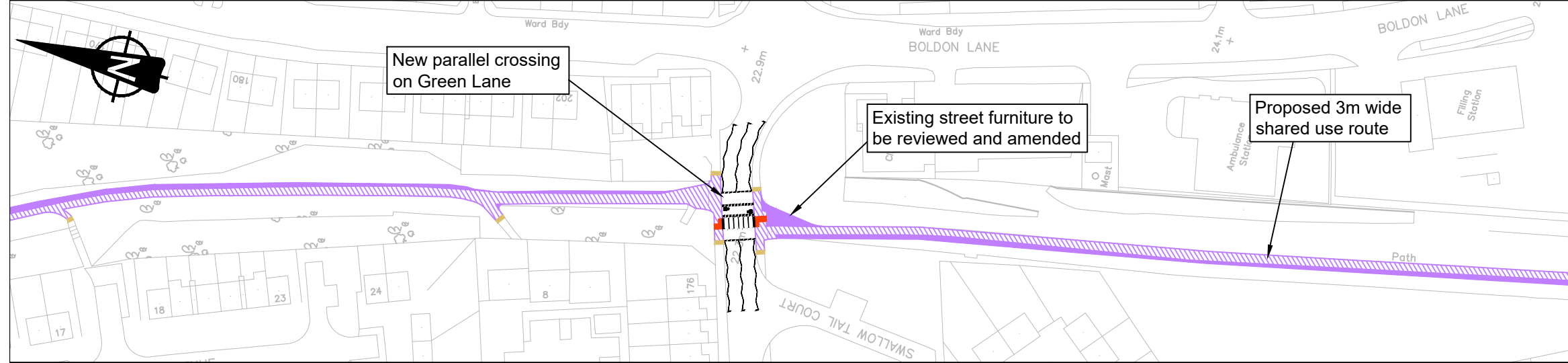
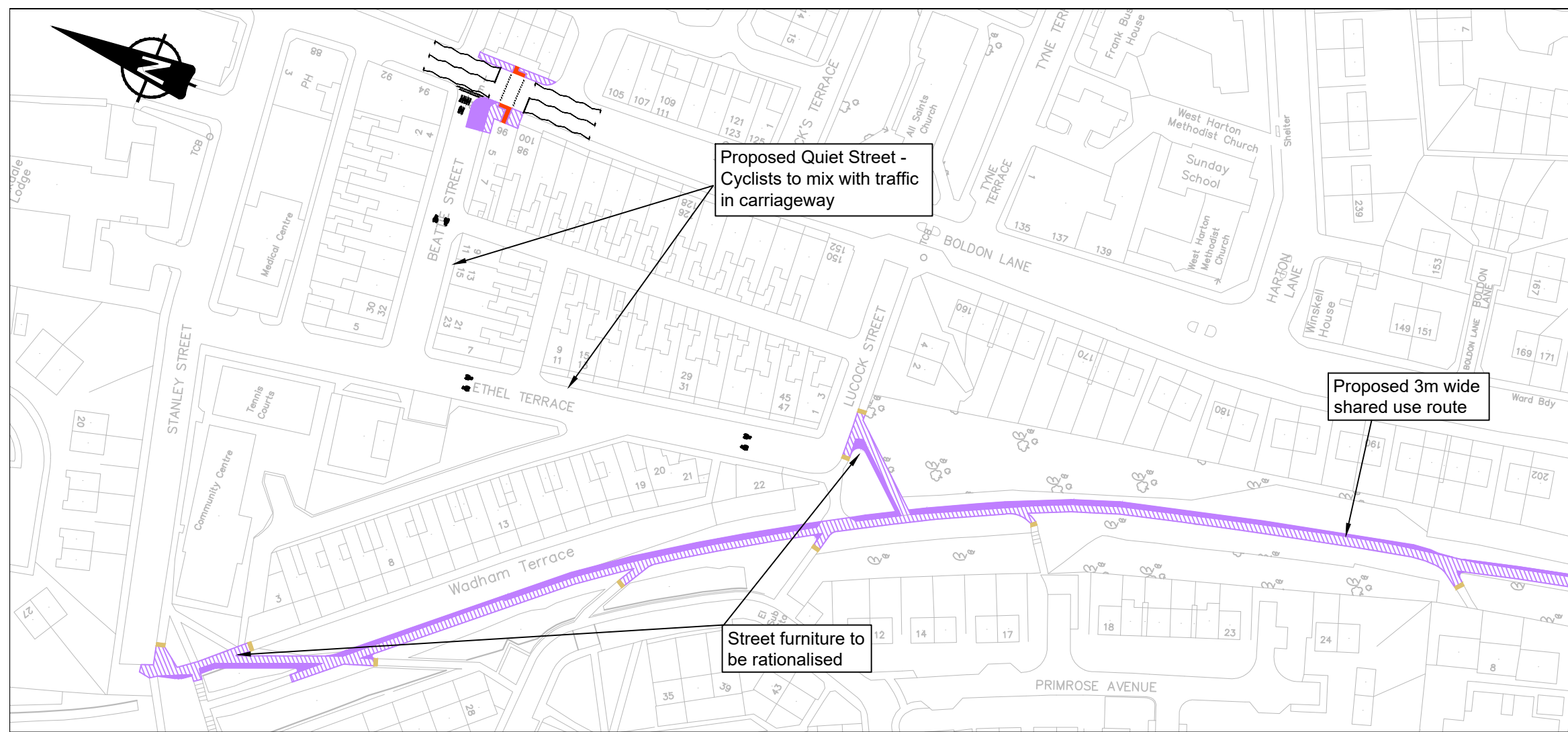

P01	04/05/2021	Issued for Information	IG
Rev	Date	Description	Chkd



South Tyneside Council
Economic Regeneration

David Cramond - Corporate Director
Town Hall & Civic Offices, Westoe Road, South Shields, Tyne & Wear, NE33 2RL
Telephone: (0191) 427 1717 Fax: (0191) 455 7770

Project
**TCF Healthier Metros
Chichester Metro Station
Olive Street to Biddick Hall**

Drawing Title
**Outline Design
Sheet 2 of 2**

Drawn by	GW	Date	04/05/2021	P01
Checked by	IG	Date	04/05/2021	
Scale	1:1250	Size	A3	

Project Code	Drawing Number
HAT/1052021	05-2